

14 ADJUST LATCHES AND SECURE TOP & BOTTOM LOCKING SCREWS.

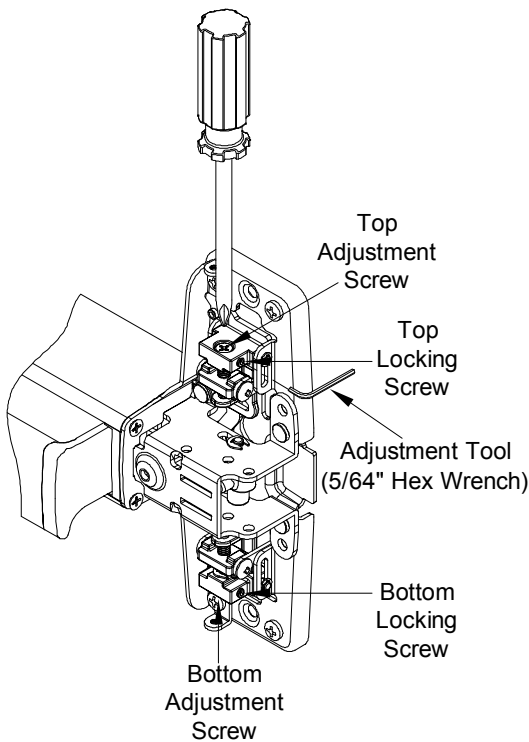

1. Depress push bar to retract the latch bolt and open the door.
2. Check top latch for HOLDBACK (Latchbolt stays retracted in latch case). **See Figure 1**
3. Loose top locking screw.
4. Rotate top adjustment screw until top latchbolt is fully retracted.
5. Release top latchbolt. **See Figure 2**
6. Check top latchbolt for DEADLOCK (Latchbolt should not push in).
7. Rotate top adjustment screw until top latchbolt is in DEADLOCK.
8. Tighten top locking screw.
9. Depress push bar and retract latchbolt.
10. Make sure top latchbolt stays retracted as shown. **See Figure 1**
11. Loose bottom locking screw.
12. With top latchbolt still retracted, adjust bottom rod by rotating bottom adjustment screw, so latchbolt clears floor and bottom strike in HOLDBACK. **See Figure 3**
13. Release top latchbolt. **See Figure 2**
14. Check bottom latchbolt for DEADLOCK.
15. Tighten bottom locking screw.
16. Open and close door several times and check device operation and function of DEADLOCK & HOLDBACK.

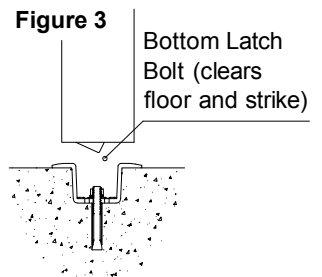
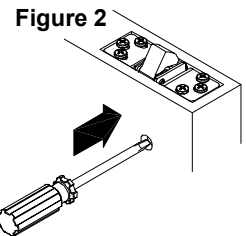
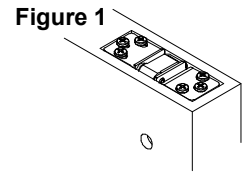

FRAME PREPARATION

216F STRIKES

FRONT VIEW

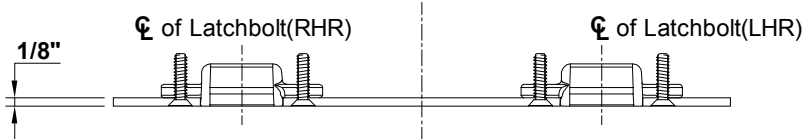

☉ Double Door Application

BOTTOM VIEW

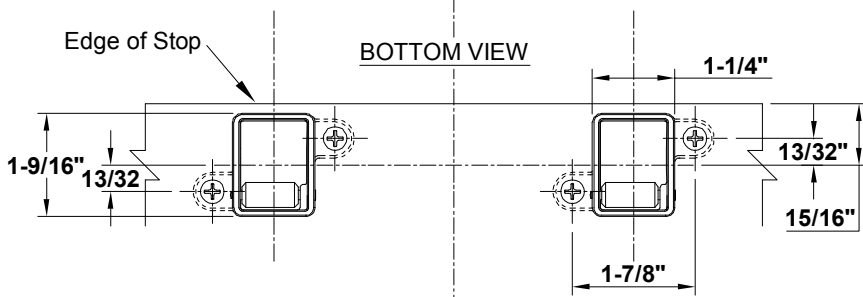

RELEASE PLUNGER

SIDE VIEW

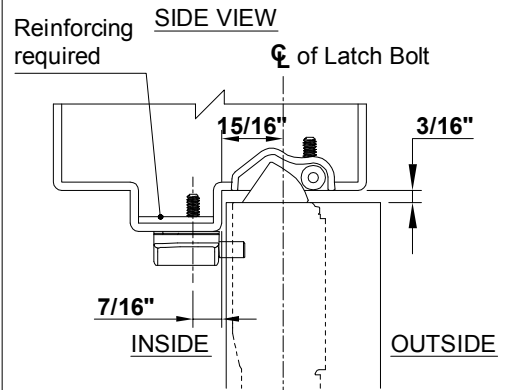

BOTTOM VIEW

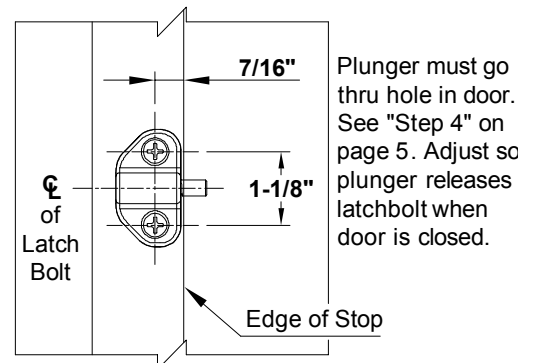

INSTALL FIRE BOLT

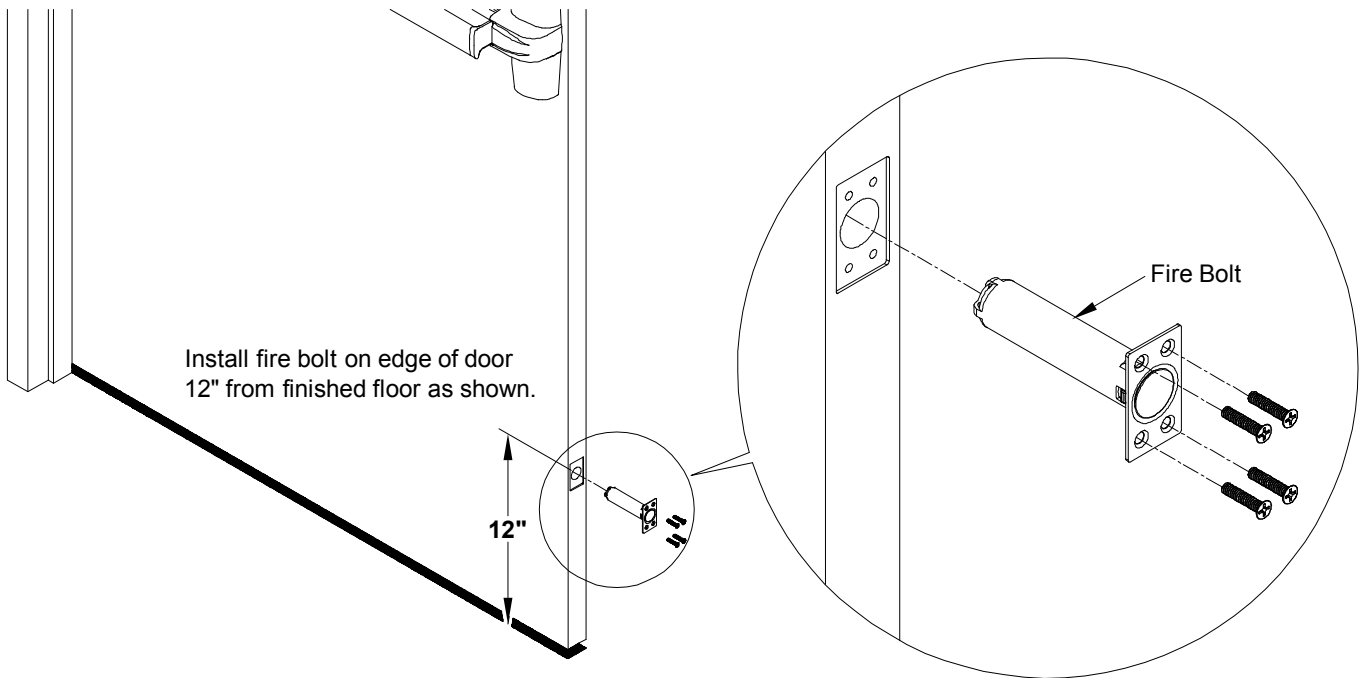

NOTE: Fire rated device with less bottom rod (LBR) applications must use FIRE BOLT.

CUT TOP ROD / EXTEND TOP ROD

CUT TOP ROD

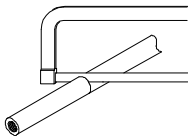

Step 1: Make sure the flat side of rod, and measure amount to cut off rod.

NOTE: Rod cutting is required for doors shorter than 7'.

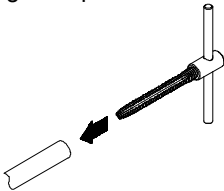

Step 2: Tap #1/4-20 ; 1" deep.

EXTEND TOP ROD

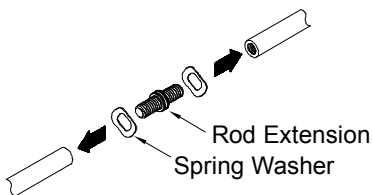

Install rod extension & spring washer to connect two(2) rods tightly.

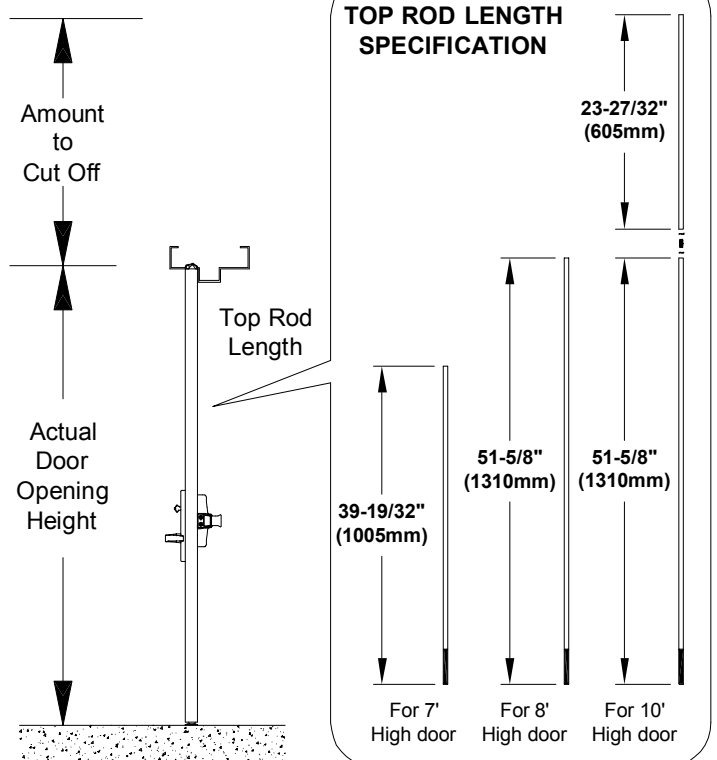

OPTIONAL DOGGING

CYLINDER DOGGING

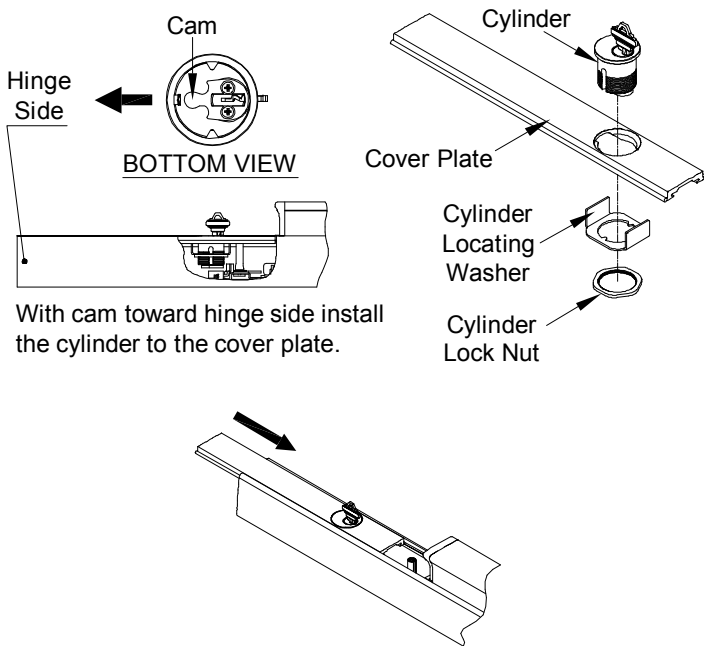

With cam toward hinge side install the cylinder to the cover plate.

Slide cover plate in position in the mechanism case.

DOGGING CHECK

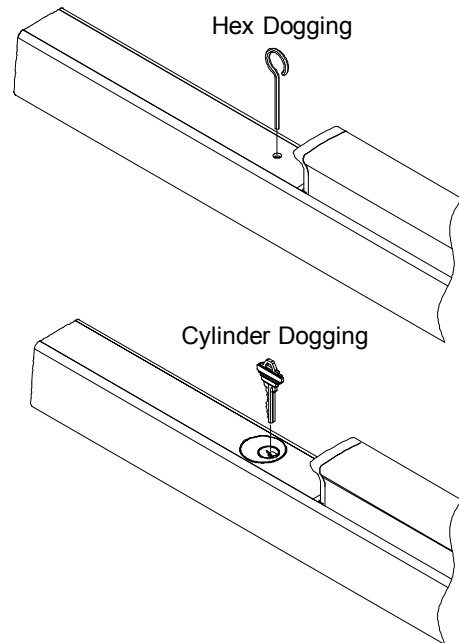

Depress push bar and turn hex wrench or key one full turn for dogging check.

CUT DEVICE (IF REQUIRED)

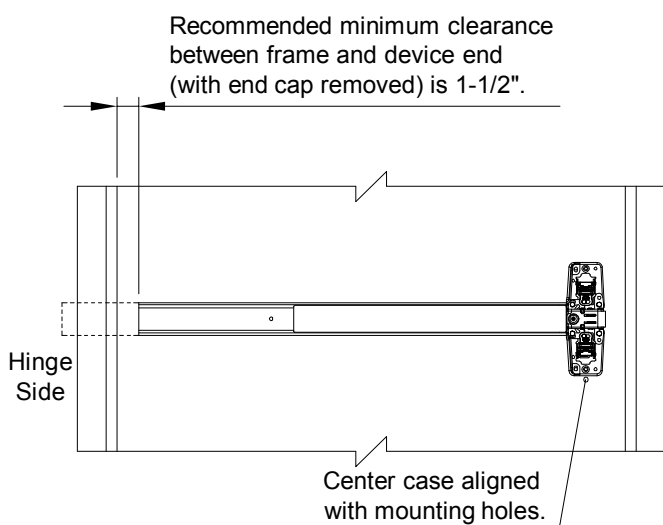

Recommended minimum clearance between frame and device end (with end cap removed) is 1-1/2".

Center case aligned with mounting holes.

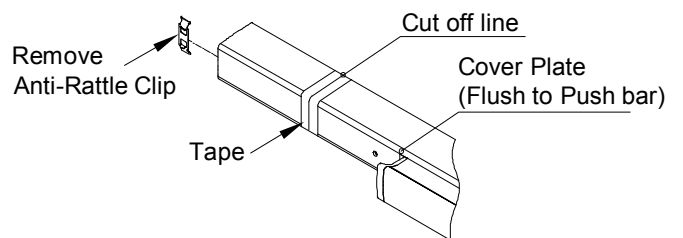

1. With anti-rattle clip removed, tape and mark area being cut.

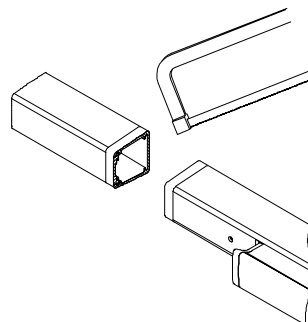

2. Cut off device and deburr.
NOTE: Device must be cut square for proper end cap fit.

